



Safespace Design Pack - Home

The following are instructions on how to produce a plan of the room where the Safespace will be situated. This plan will allow us to determine the correct size of the Safespace as well as the position of the Safespace door and windows.

There are two drawings to print out and complete:

1. **Room Heights** – used to note the window, pendant light and ceiling heights. See page 5.
2. **Plan of Room** – used to note the dimensions of the room. See page 6.

It is **essential** to include the location, width & depth of anything which protrudes into the room e.g. radiators, chimney breasts, wardrobes etc.

Please indicate on the plans if there is any specialist equipment that needs to remain in the room after the Safespace is installed. Please include the full dimensions of this on the room plan. Also add dimensions & location of any tube holes needed in the Safespace for medical equipment, or leads etc.

It is helpful to send us additional sketches or photographs if the room has any complex features, such as alcoves.

Please post, fax or email the completed drawings together with the **Contact Details and Options form** including the **colour chart** to Safespaces – contact details below.

If you have any questions when completing the room plan, please contact us as we are happy to assist.

Safespaces (Cornholme) Ltd
361 Burnley Road
Todmorden
Lancs
OL14 7DH
Tel/fax +44 (0)1706 816274
Email enquiries@safespaces.co.uk



Safespace Optional Extras

1) Removable Window Blinds

Window blinds are usually made from the same colour PVC as your Safespace. They are fitted with Velcro on the outside of the Safespace so that the carer has control of their use. They are useful to darken the Safespace room or to create a low stimulation environment.

2) Visual Deterrent Panels

A 25cm space is required around the Safespace in order to allow the PVC walls to flex out. This creates a gap around the Safespace which a user could try to slip into, and which may be too small for adults to follow. Visual deterrent panels conceal this gap and are recommended for those who have the ability & the inclination to enter the gaps around the Safespace. However they are not a substitute for supervision. The panels are usually made from the same colour PVC as your Safespace. They extend from the corners of the Safespace and are fixed to the wall of the room with a wooden batten. They are designed as a visual deterrent and are only as strong as the fixings.

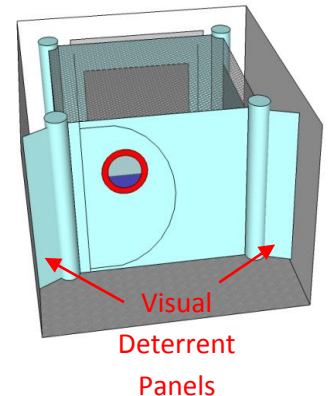

3) White Wall

A white wall is an excellent background on which to project images. We also supply projector kits & sensory lighting as an accessory. Please ask for details.



4) Standard mattress

Our standard mattress is covered in PVC and designed to fit snugly into the Safespace. It is waterproof and cannot be pierced by teeth.



5) Memory foam mattress

Our memory foam mattress has a Lycra cover. It is designed to fit snugly into the Safespace and is water resistant. It is not suitable for users who bite objects as it can be pierced by teeth.

6) Water resistant seams

Option 1- Water resistant floor seams. We would recommend this if the Safespace will be used by more than one person or there are continence issues.

Option 2- Water resistant floor & wall seams up to height of 91cm. We would recommend this where liquid continence is a particular issue.

Option 3- Water resistant floor & wall seams up to a height of 2 metres. An enhanced version of Option 2, up to a maximum of 2metres.

Contact Details and Safespace Options

Details of person requesting quote	
Name	Job title/Role
Address	
Phone	Email
Mobile No	Fax

Details of person using Safespace (add separate form if more than one user)	
Parent/Carer's name	Email
Phone	Mobile No
User's Name	Age
Address (location of Safespace)	
Medical condition/s (if any)	
Does client have diagnosis Yes/No State diagnosis	
Mobility/Does user need hoisting?	
Behaviours	
Sleep patterns/issues	
How do you intend to use the Safespace? E.g. for sleep, sensory space etc?	
Has client had an assessment of need regarding the Safespace? Yes/No	
Has funding been identified?	

Safespace options (see options sheet for details)	Please tick
Standard single mattress with PVC cover (183cm x 91cm x 20cm)	
Memory foam single mattress with Lycra cover (183cm x 91cm x 20cm)	
White wall (for projecting onto)	
Removable window blinds	
Water resistant floor seams (option 1)	
Water resistant floor seams up to a height of 91cm (option 2)	
Water resistant floor seams up to a height of 2 metres (option 3)	
Tube holes required? (state diameter & number)	
Sensory equipment (please say which)	
Visual deterrent panels	
If you would like Visual deterrent panels please say what the walls that they will be attached to are made of	
Are there any pipes/boxes/or skirting boards protruding into the room that could interfere with the siting of visual deterrent panels?	
Is there underfloor heating in the room where the Safespace will be sited?	
Signature:	Date:



These are our standard colours. When choosing colours, please consider how calm or lively an environment you wish to create. If there is a particular colour you require please contact us to discuss. The colours below may not be an exact representation so please check our website. Please choose colours for wall, floor, mattress & external corner from selection below

WALL COLOUR: _____



FLOOR COLOUR: _____

MATTRESS COLOUR: _____

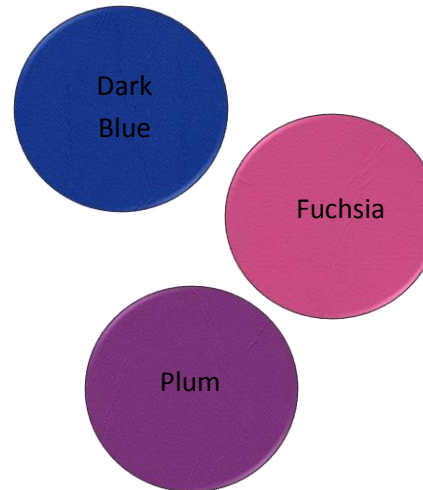

EXTERNAL CORNER COLOUR: _____



Room Heights

Measure the heights (cm) of the room where the Safespace will be situated and enter the measurements in the brackets. See example below.

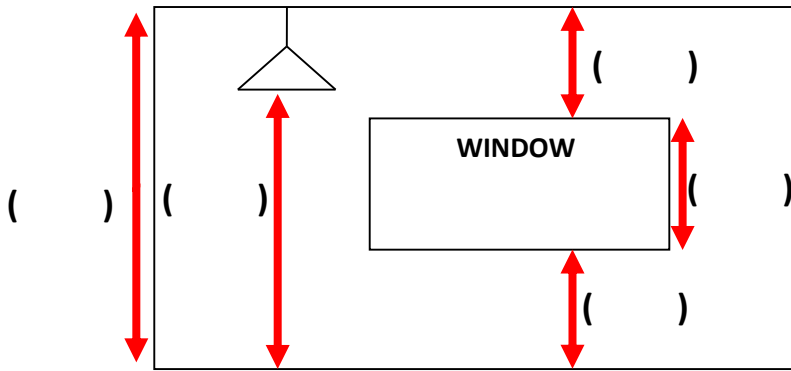
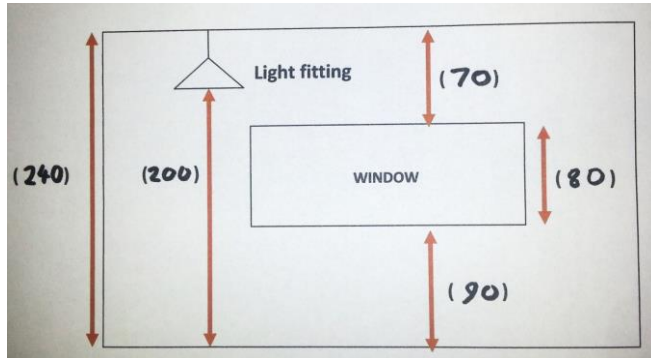

Room Plan

Using the blank plan on the next page, follow the instructions and complete the plan. A completed example is shown below. All measurements are in centimetres

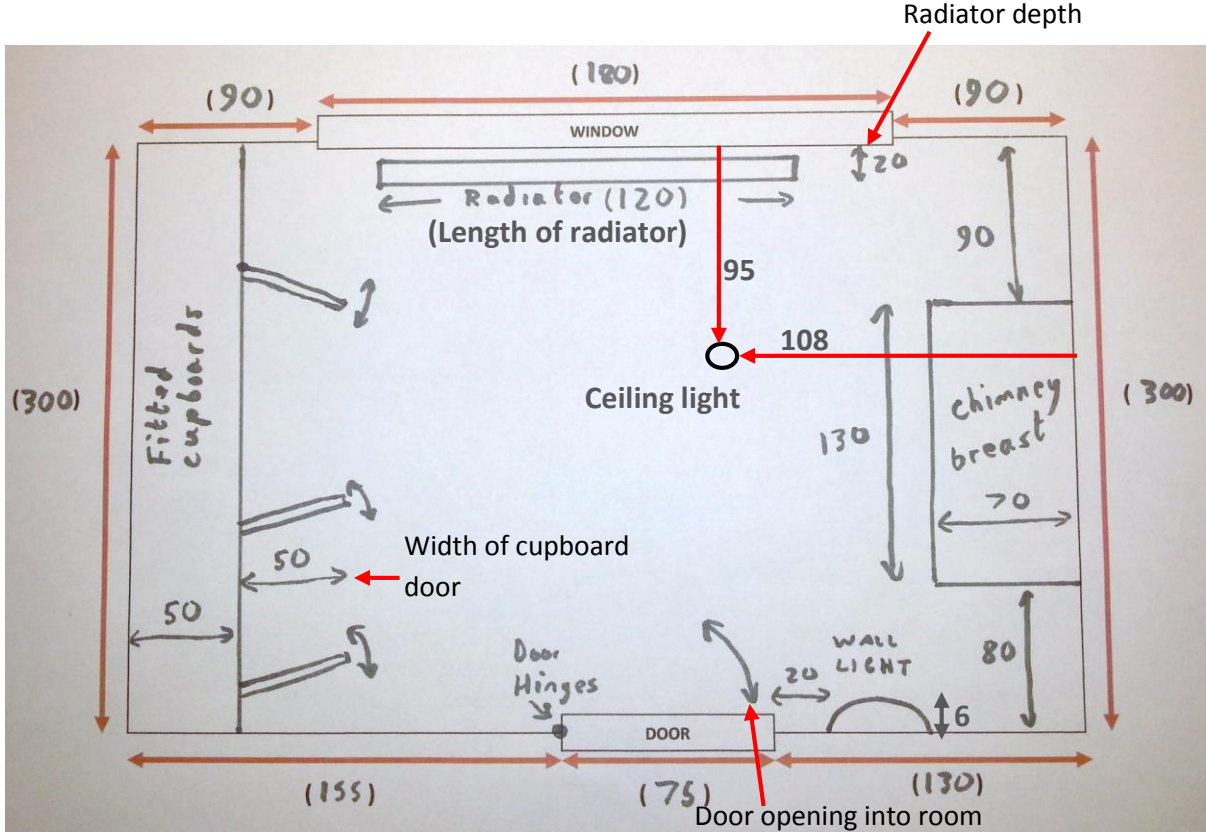

Blank Room Plan Template

On your plan, draw and label all doors (marking which side the hinges are on & direction of opening). Then add windows, radiators/wall heaters, fitted furniture, wall-mounted TVs (including depth), loft hatch and wall/ceiling lights. Please show on plan whether door opens inward or outwards.

1. Measure the room and put the measurements (cm) in the relevant brackets – see worked example. All wall measurements should be taken along the floor between the skirting boards or surface pipe-work and be in centimetres (cm).
2. Measure all the features listed above and add the measurements to the plan.
3. Show position of ceiling light fitting in room including distance from walls (see example)

